



AquaFlow™

Whole House Salt-Free Descaler

Description

The AquaFlow™ Descaler is a water conditioning system designed to reduce the effects of hard water, specifically scale deposits that form on surfaces such as bathtubs, sinks, and shower walls.

The AquaFlow™ employs a galvanic water treatment process to prevent and reduce the formation of lime-scale buildup. by using a magnetic field to alter the behavior of mineral particles in the water, keeping them suspended rather than allowing them to accumulate on surfaces.

As water flows through the stainless steel chamber, the device generates a small galvanic current. This current changes the crystalline structure of minerals dissolved in the water. As a result, these minerals no longer form hard scale deposits on the surfaces they contact.

Importantly, this process does not alter the chemical composition of the water. Instead, it changes the physical structure of the minerals. For example, calcite, which easily adheres to surfaces, is converted into aragonite, a form that remains dissolved in water and does not precipitate as scale.

While the AquaFlow™ does not reduce water hardness, it effectively mitigates the problems typically caused by hard water.

The system operates without needing an external power source, requires no maintenance, and does not rely on chemical additives.

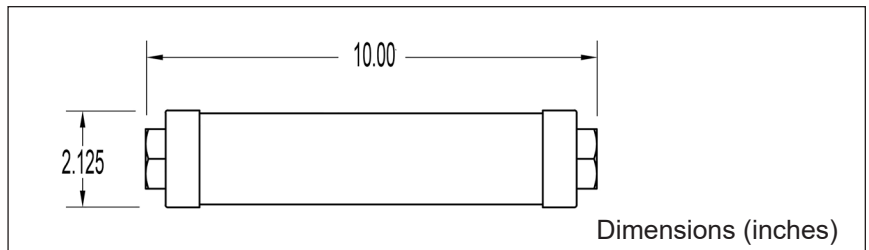

Applications

- ▶ Whole House Plumbing
- ▶ Appliances (Dish Washer, Water Heater)
- ▶ Taps, Shower Heads
- ▶ Thermostatic Valves

Benefits

- ▶ Innovative Long-Term Scale Inhibiting
- ▶ Eco-Friendly 
- ▶ Healthy and Safe 



Installed inline

small footprint, no tank required



Salt-Free Water Treatment

no added salt (sodium-chloride) or other chemicals (potassium chloride), no health concerns, no environmental damage due to high brine content



Nothing is Removed from the Water

vital minerals for human health are maintained



Maintenance-Free 24/7 Operation

no backwashing or resin regeneration needed



Power-Free

no operational costs



Improved Water Quality

no cloudy water, no white spots on dishes, prevents mineral buildup

Product Name:	AquaFlow™ Whole House Water Descaler
Product Model:	AFD-1
Scaling Principle:	Pure Physical Ion Polarization
Inlet & Outlet:	DN25 / 1" Female tapered thread
Chamber Material:	304 Stainless Steel
Installation Method:	Horizontal or Vertical
Water Quality:	Municipal Tap Water
Plumbing Pipe:	CPVC / PVC / PEX / copper / PPR
Application Pressure:	0.15 - 1 MPa / 22 - 145 psi / 1.5 - 10 bar
Temperature Range:	T _{min.} = 5 °C (41 °F), T _{max.} = 100 °C (212°F)
Rated Flow:	4 m ³ /h / 67 LPM / 17 GPM
Expected min. Lifetime:	10 Years
Product Size:	155 mm X 54 mm / 10" X 2-1/8"
Shipping Weight:	3 lbs / 1.5 kg

Recommended Water Properties:	
pH	6.5 - 8.5
Hardness	up to 25 dH° / 25 gpg / 466 mg/L
TDS	< 1000 ppm
Iron (Fe)	< 2 mg/L
Turbidity	< 1 NTU

Specifications subject to change

Galvanic Water Treatment Process

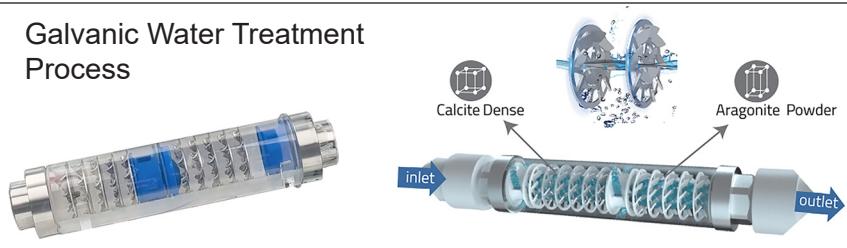

Standard Installation on Water Supply System

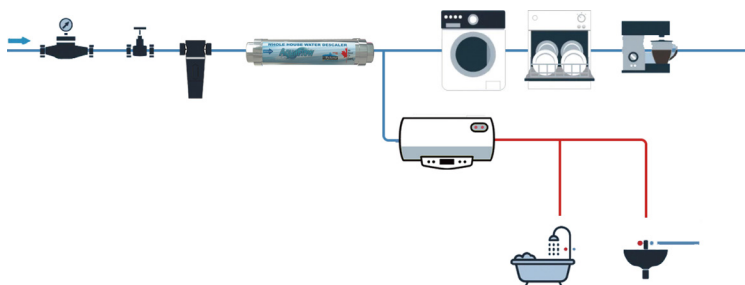

Additional Features

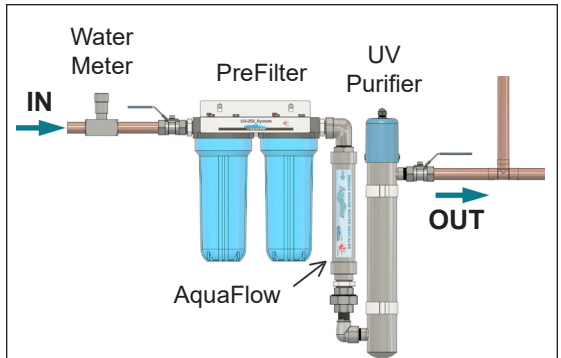

For a complete Whole House Water Treatment it is highly recommended to add a UV Disinfection system after the Descaler for top water quality and peace of mind.

Recommended Configuration

In order to maintain peak performance, the Descaler should be installed with a pre-filter set, according to the flow rate required for the house or application.

